

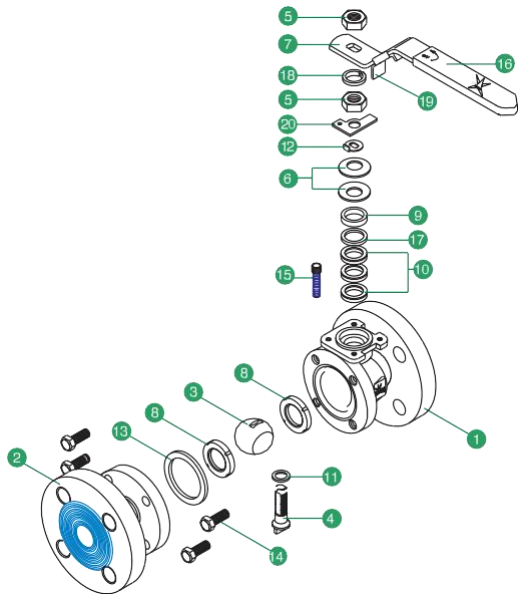

## BALL VALVE - 2 Piece Flanged Class 150

### SPECIFICATIONS SERIES 90 F/PORT

Design to ANSI B16.34, BS 5351, DIN 3337  
 Investment Casting  
 Blow-out proof system, Anti-static device  
 Full Bore 2 piece body construction  
 Test and Inspection to API598

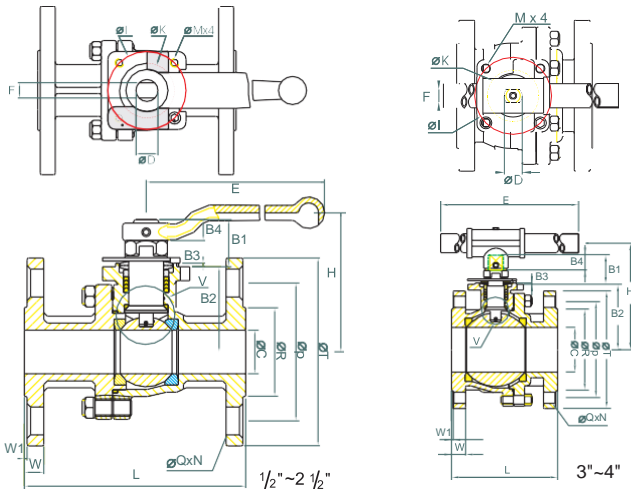

### MATERIALS - CONSTRUCTION

|    | Part Name         | Material                        | Qty |
|----|-------------------|---------------------------------|-----|
| 1  | Body              | ASTM A351 CF8M<br>ASTM A216 WCB | 1   |
| 2  | End Cap           | ASTM A351 CF8M<br>ASTM A216 WCB | 1   |
| 3  | Ball              | SUS 316                         | 1   |
| 4  | Stem              | SUS 316                         | 1   |
| 5  | Stem Nut          | SUS 304                         | 2   |
| 6  | Belleville Washer | SUS 301                         | 2   |
| 7  | Handle            | SUS 304                         | 1   |
| 8  | Seat              | RPTFE                           | 2   |
| 9  | Gland             | SUS 304                         | 1   |
| 10 | V-ring Packing    | PTFE                            | §   |
| 11 | Stem Seal         | RPTFE                           | 1   |
| 12 | Lack Saddle       | SUS 304                         | 1   |
| 13 | Joint Gasket      | PTFE                            | 1   |
| 14 | Bolt (Stud & Nut) | SUS 304                         | *   |
| 15 | Stop Pin          | SUS 304                         | 1   |
| 16 | Handle Sleeve     | Vinyl                           | 1   |
| 17 | Gland Packing     | 25% RTFE                        | 1   |
| 18 | Washer            | SUS 304                         | 1   |
| 19 | Locking Device    | SUS 304                         | 1   |
| 20 | Locking Plate     | SUS 304                         | 1   |



### DIMENSIONS (in mm)

| DN  | B1 <sub>+0.5</sub> | B2    | B3 | B4 <sub>+1.5</sub> | OC  | OD   | E   | F    | H     | OI  | OK   | L     | M               | N | OP  | OQ | OR    | OT    | W    | W1  | W(kg) | ISO5211 |
|-----|--------------------|-------|----|--------------------|-----|------|-----|------|-------|-----|------|-------|-----------------|---|-----|----|-------|-------|------|-----|-------|---------|
| 15  | 22.4               | 34.5  | 1  | 9.8                | 15  | 11.1 | 165 | 8.0  | 60.6  | 42  | 30   | 108.3 | M5(10-24UNC)    | 4 | 60  | 16 | 35.1  | 88.9  | 11.2 | 1.6 | 1.69  | F04     |
| 20  | 21.4               | 41.1  | 1  | 8.8                | 20  | 11.1 | 165 | 8.0  | 67.21 | 42  | 30   | 117.3 | M5(10-24UNC)    | 4 | 69  | 16 | 42.9  | 98.6  | 11.1 | 1.5 | 2.1   | F04     |
| 25  | 26.5               | 49.5  | 2  | 9.6                | 25  | 14.3 | 200 | 9.7  | 82.9  | 50  | 35   | 127.0 | M6(1/16"-20UNC) | 4 | 85  | 16 | 50.8  | 108   | 11.2 | 1.6 | 3.02  | F05     |
| 40  | 34.8               | 78.3  | 2  | 14.8               | 38  | 19.0 | 250 | 12.0 | 115.3 | 70  | 55   | 165.1 | M8(5/16"-18UNC) | 4 | 110 | 16 | 73.2  | 127   | 14.3 | 1.6 | 6.17  | F07     |
| 50  | 34.8               | 86.4  | 2  | 14.8               | 50  | 19.0 | 250 | 12.0 | 123.4 | 70  | 55   | 178.3 | M8(5/16"-18UNC) | 4 | 125 | 19 | 91.9  | 152.4 | 15.9 | 1.6 | 8.7   | F07     |
| 65  | 34.8               | 97.4  | 2  | 14.8               | 65  | 19.0 | 250 | 12.0 | 134.4 | 70  | 55   | 190.3 | M8(5/16"-18UNC) | 4 | 145 | 19 | 104.6 | 177.8 | 17.6 | 1.6 | 13.62 | F07     |
| 80  | 46.0               | 107.4 | 2  | 21.8               | 80  | 24.0 | 354 | 15.0 | 176.5 | 102 | 70.0 | 203.5 | M10(3/8"-16UNC) | 8 | 160 | 19 | 127   | 190.5 | 19.1 | 1.6 | 18.58 | F10     |
| 100 | 45.5               | 122.4 | 2  | 21.8               | 100 | 24.0 | 354 | 15.0 | 191   | 102 | 70.0 | 229.5 | M10(3/8"-16UNC) | 8 | 180 | 19 | 157.2 | 228.6 | 23.9 | 1.6 | 29.5  | F10     |